

SELENE LED TRACK LIGHTING SERIES



The **Selene Track Lighting SERIES** is essential component for any application requiring directional adjustability and accent lighting effects. Shops, galleries, hotels, and homes are some of the many venues that can benefit from these features. Furthermore, track lighting allows for great diversity in tailoring the perfect lighting solution for any type of exhibition. A single track system can support a large number of these adjustable fixtures, a number which may be amended at any time without intrusive modifications to the space.

Because track lights play an important role in exhibitions, operating hours can be incredibly high. With LED technology, these track lighting fixtures will provide far better performance ratings, and last many years longer than traditional lighting sources.

SEL—TL Series

Specifications

Model	SEL-TL-005	SEL-TL-008	SEL-TL-012	SEL-TL-015	SEL-TL-020
Lumen Output	425 lm	680 lm	1080 lm	1275 lm	1800 lm
Wattage	5 W	8 W	12 W	15 W	20 W
Delivered Efficacy	85 lm/W	85 lm/W	90 lm/W	85 lm/W	90 lm/W
Voltage	AC100-277V	AC100-277V	AC100-277V	AC100-277V	AC100-277V
Available Color Temp.	2700-5000 K	2700-5000 K	2700-5000 K	2700-5000 K	2700-5000 K
L70	≥50,000 hours	≥50,000 hours	≥50,000 hours	≥50,000 hours	≥50,000 hours
CRI	80, 90, 95	80, 90, 95	80, 90, 95	80, 90, 95	80, 90, 95
Beam Angle	18°, 24°, 38°, 60°	18°, 24°, 38°, 60°	18°, 24°, 38°, 60°	18°, 24°, 38°, 60°	18°, 24°, 38°, 60°
Weight	0.35 kg	0.35 kg	0.68 kg	0.68 kg	1.18 kg
Dimensions	Ø55mm×95mm [Ø2.2"×3.7"]	Ø55mm×95mm [Ø2.2"×3.7"]	Ø70mm×130mm [Ø2.8"×5.1"]	Ø70mm×130mm [Ø2.8"×5.1"]	Ø90mm×155mm [Ø3.5"×6.10"]
Warranty	3 years	3 years	3 years	3 years	3 years

Model	SEL-TL-025	SEL-TL-030	SEL-TL-035	SEL-TL-040
Lumen Output	2125 lm	2700 lm	2975 lm	3280 lm
Wattage	25 W	30 W	35 W	40 W
Delivered Efficacy	85 lm/W	90 lm/W	85 lm/W	82 lm/W
Voltage	AC100-277V	AC100-277V	AC100-277V	AC100-277V
Available Color Temp.	2700-5000 K	2700-5000 K	2700-5000 K	2700-5000 K
L70	≥50,000 hours	≥50,000 hours	≥50,000 hours	≥50,000 hours
CRI	80, 90, 95	80, 90, 95	80, 90, 95	80, 90, 95
Beam Angle	18°, 24°, 38°, 60°	18°, 24°, 38°, 60°	18°, 24°, 38°, 60°	18°, 24°, 38°, 60°
Weight	1.18 kg	1.38 kg	1.38 kg	1.48 kg
Dimensions	Ø90mm×155mm [Ø3.5"×6.10"]	Ø90mm×165mm [Ø3.5"×6.50"]	Ø90mm×165mm [Ø3.5"×6.50"]	Ø90mm×165mm [Ø3.5"×6.50"]
Warranty	3 years	3 years	3 years	3 years

SEL—TL Series

Dimensions

SEL-TL-005, SEL-TL-008

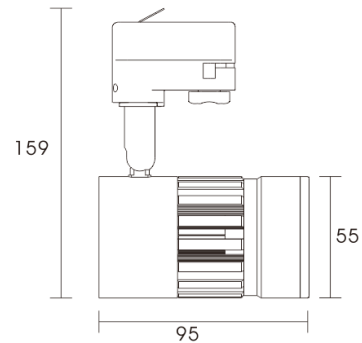

SEL-TL-012, SEL-TL-015

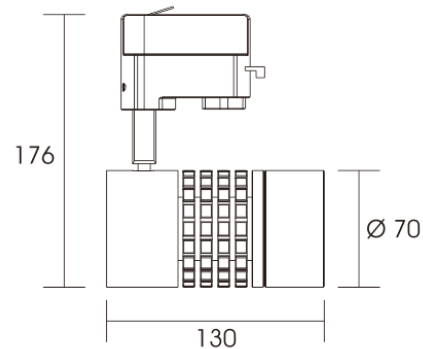

SEL-TL-020, SEL-TL-025

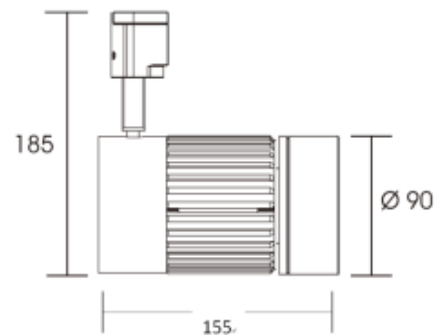

SEL-TL-030, SEL-TL-035, SEL-TL-040

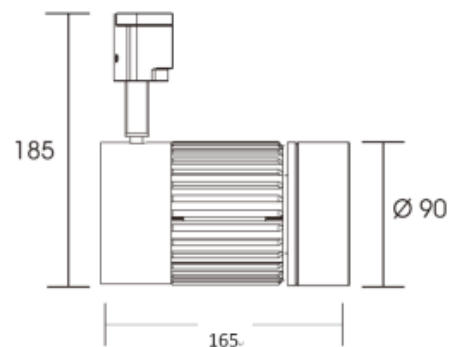

Installation

Installation Overview

Compatible with 3-Wire “H” Style Track System only. Track system is not provided.

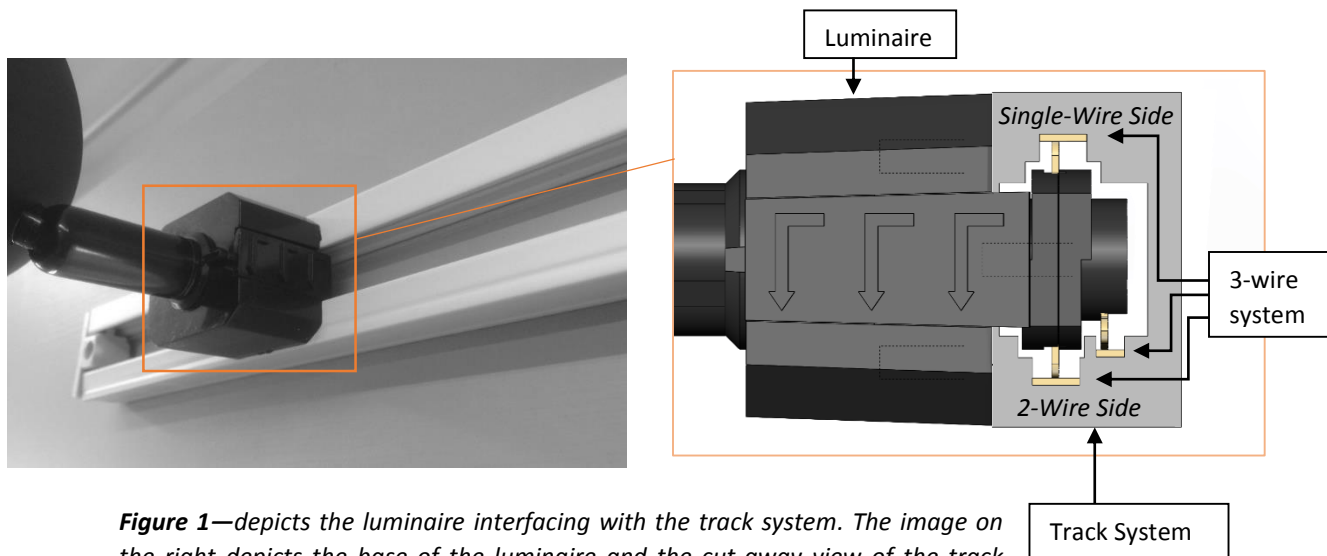

Figure 1—depicts the luminaire interfacing with the track system. The image on the right depicts the base of the luminaire and the cut-away view of the track system. **For luminaire orientation, refer to this image.**

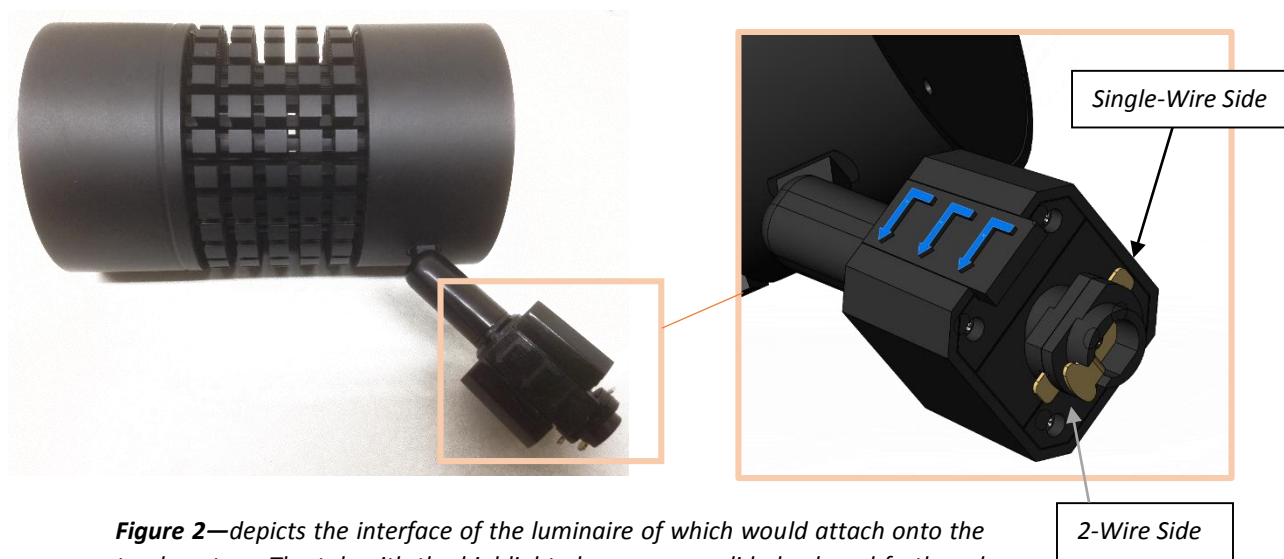

Figure 2—depicts the interface of the luminaire of which would attach onto the track system. The tab with the highlighted arrows can slide back and forth and will lock the fixture base into the track system. These arrows should **indicate which side of the fixture base should be facing the 2-wire side (shown in Figure 1) in a 3-wire track system, regardless of track system orientation.**

SEL—TL Series

Luminaire Installation Procedure

Turn off power before installing or making any adjustments on the luminaire. Verify installation codes with your certified electrical contractor.



Turn off Mains

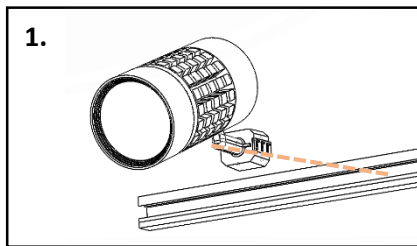

Figure 3

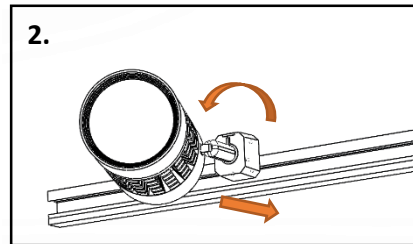

Figure 4

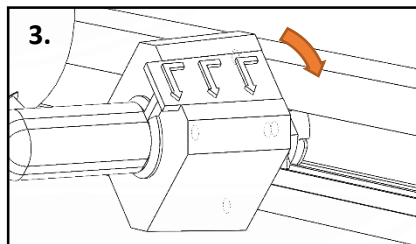

Figure 5

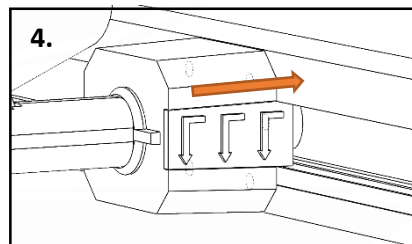

Figure 6

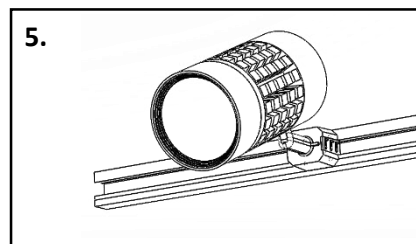

Figure 7

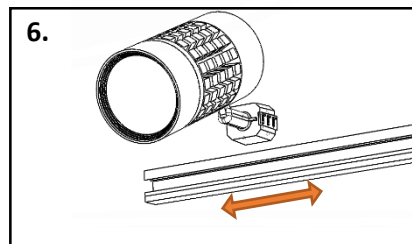

Figure 8



Turn on Mains

STEP 1:

Align the track light fixture at the desired location on the track. Make sure that the arrows on the base are pointing in the correct direction (shown previously in Figure 1 & 2), as specified in the **Installation Overview** sub-section.

STEP 2:

Rotate the fixture's base by 90° in the counter-clockwise direction (as shown in Figure 4). Push the fixture base into the track. The fixture should slide in smoothly. The tab with the arrows should push back as fixture is inserted into the track.

STEP 3:

As the base of the fixture sits flush against the track system, carefully rotate the track lighting fixture 90° in the clockwise direction (as shown in Figure 5).

STEP 4:

The tab should return to its normal position once the luminaire is correctly situated—locking the light fixture in place (as shown in Figure 6). Inspect the light fixture and verify that the arrows on the tab are pointing in the correct direction.

STEP 5 & 6:

Figure 7 shows the luminaire in its final position. If the position of the luminaire is unsatisfactory, remove the fixture completely, and move the luminaire to a more suitable location on the track. **Do not slide the luminaire along the track as it may damage the luminaire or the track.**



SEL—TL Series



The Solution for Effective LED Lighting

Visit us at
www.solidiumtech.com

Or call us at 1.604.371.4112

*Specifications and dimensions are subject to change
without notice.*